



Main Features:-

- ◆ Strainer Y. Flanged
- ◆ EN 1092 PN16
- ◆ Stainless Steel 1.4408 (CF8M)
- ◆ Working Temperature -30 to + 240C *
- ◆ Max. Working pressure 19 bar

*Temperature and pressure determined by valve body, seat etc.

Suitable Applications & Approvals:



HVAC



OIL



GAS



INDUSTRY

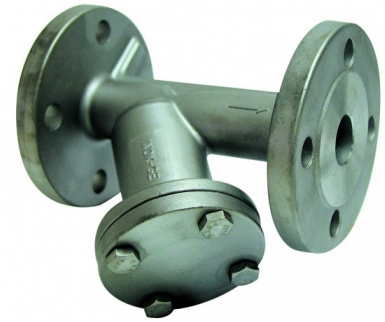

SERIES: 80247

MANUFACTURER: **GENEBRE**

VALVE MATERIALS & DIMENSIONS

ITEM	SECTION	MATERIAL	ADDITIONAL INFO / OPTIONS
1	Body	SS 1.4408	Shot Blasting
2	Cover	SS 1.4408	Shot Blasting
3	Gasket	PTFE	J2461
4	Strainer	SS AISI 316	2861
5	Bolt	SS AISI 304	n/a
6	Plug	SS AISI 316	n/a

REF	SIZE	A	D	L	P	d3	Kg
80247-04	1/2"	75	95	130	2	1	1.95
80247-05	3/4"	90	105	150	2	1	2.75
80247-06	1"	100	115	160	2	1	3.7
80247-07	1 1/4"	115	140	180	2	1	5.9
80247-08	1 1/2"	130	150	200	2	1	6.4
80247-09	2"	150	165	230	2	1	8.9
80247-10	2 1/2"	190	185	290	3.5	2	12.95
80247-11	3"	200	200	310	3.5	2	18.15
80247-12	4"	230	220	350	3.5	2	24.3
80247-13	5"	280	250	400	3.5	2	30
80247-14	6"	300	285	480	3.5	2	42
80247-16	8"	400	340	605	3.5	2	75

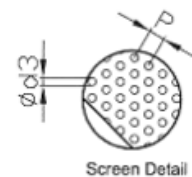
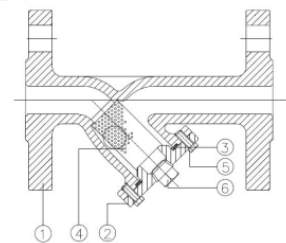
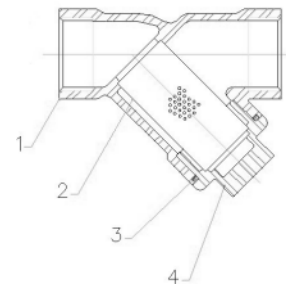

T +44 (0)1386 552369

E sales@allvalves.co.uk

W www.allvalves.co.uk

F +44 (0)1386 554227



Genebre are a global brand of industrial valves with large stocks held for fast delivery on various type of valves, sizes, end connections and materials.

SERIES: 80247

REF	SIZE	A	D	L	P	d3	Kg
80247-04	1/2"	75	95	130	2	1	1.95
80247-05	3/4"	90	105	150	2	1	2.75
80247-06	1"	100	115	160	2	1	3.7
80247-07	1 1/4"	115	140	180	2	1	5.9
80247-08	1 1/2"	130	150	200	2	1	6.4
80247-09	2"	150	165	230	2	1	8.9
80247-10	2 1/2"	190	185	290	3.5	2	12.95
80247-11	3"	200	200	310	3.5	2	18.15
80247-12	4"	230	220	350	3.5	2	24.3
80247-13	5"	280	250	400	3.5	2	30
80247-14	6"	300	285	480	3.5	2	42
80247-16	8"	400	340	605	3.5	2	75

KV VALUES:

- Kv = Flow rate of water in cubic meter per hour (m3 /h) that will generate a pressure drop of 1 bar across the valve.

- For further information, please email sales@allvalves.co.uk

TORQUES:

- Maximum recommended torque to tighten the flanges' screws

- For further information, please email sales@allvalves.co.uk

VALVE MATERIALS & DIMENSIONS

REF	SIZE	TORQUE Nm	REF	SIZE	Kv
80247-04	1/2"	-	80247-04	1/2"	3.3
80247-05	3/4"	-	80247-05	3/4"	6.6
80247-06	1"	-	80247-06	1"	9.7
80247-07	1 1/4"	50	80247-07	1 1/4"	14.9
80247-08	1 1/2"	50	80247-08	1 1/2"	26.6
80247-09	2"	50	80247-09	2"	35.4
80247-10	2 1/2"	50	80247-10	2 1/2"	67.2
80247-11	3"	50	80247-11	3"	96.1
80247-12	4"	50	80247-12	4"	149
80247-13	5"	60	80247-13	5"	198.5
80247-14	6"	60	80247-14	6"	294.6
80247-16	8"	80	80247-16	8"	462.5

All Valves

AllValves Online™ have used decades of experience in the valve industry to select a range of products that match the Allvalves Online ethos - value for money. All Valves Products are from reputable sources and have been sold in significant quantities for many years, are installed in a wide variety of applications, and are known to be durable in service.

Pressure temperature rating

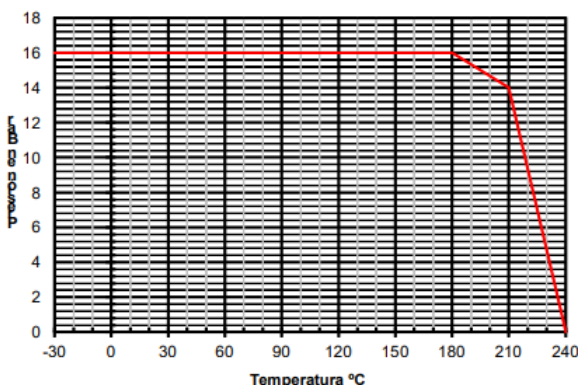

GENEBRE

Genebre is a leading company and world reference in fluid control and high-quality taps. They control all the creation processes, responding to the specific needs of each market: from the initial concept and design of the product to the production and commercialization.

T +44 (0)1386 552369

E sales@allvalves.co.uk

W www.allvalves.co.uk

F +44 (0)1386 554227

